

FOR SALE/LEASE

**2376 Main Street, Ferndale, WA
- Mountainview Professional Center -**



Rare Office / Neighborhood Retail Condominium

- Located on the western end of Main Street in Ferndale
- Approximately 1,639 rentable SF, open layout with one closed office
- Excellent visibility and signage
- Quiet neighborhood location
- Excellent location for office or neighborhood retail services
- Good parking on-site, on the bus line
- Neighboring tenants include: London Health Center, USKH, Patricia Con DDS



**Sales, Leasing, Management
Office, Retail and Industrial Properties**

114 W Magnolia Street, Suite 302, Bellingham, WA 98225

For information contact:

Tracy Carpenter or **Jim Bjerke**

(360) 671-4200 ex 3114

tracy@pacificcontinentalrealty.com

jim@pacificcontinentalrealty.com

Floor Plan

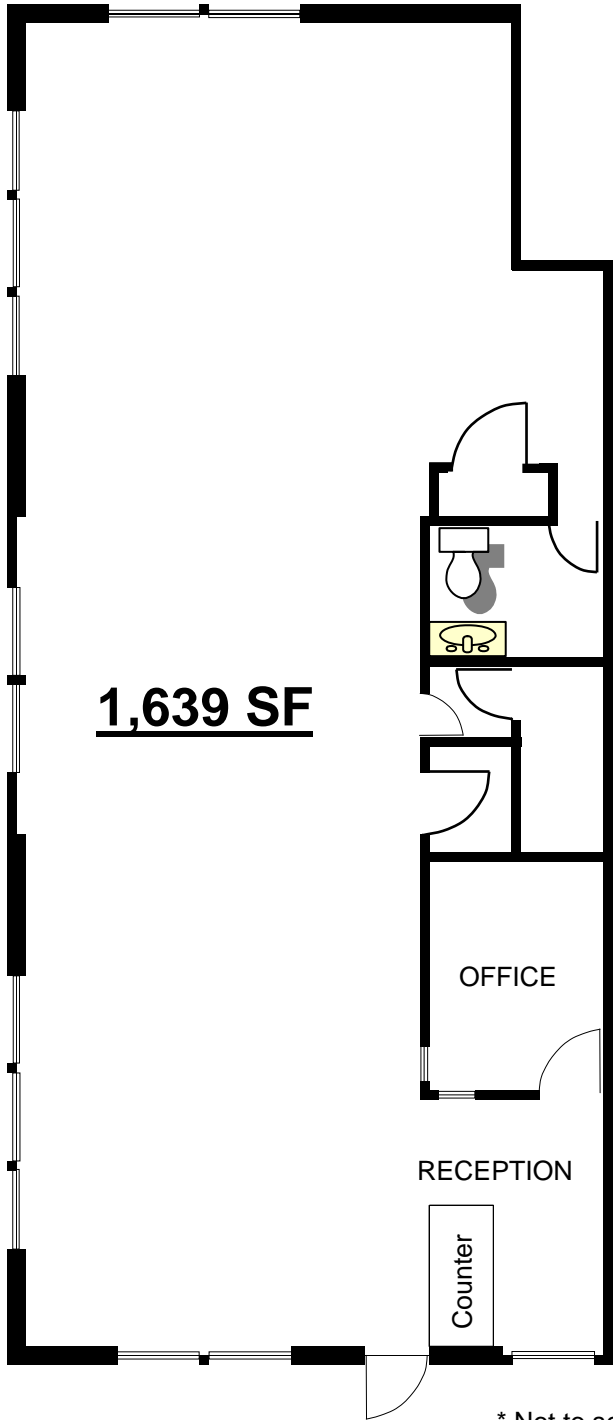

Sales, Leasing, Management
Office, Retail and Industrial Properties

114 W Magnolia Street, Suite 302, Bellingham, WA 98225

For information contact:

Tracy Carpenter or **Jim Bjerke**

(360) 671-4200 ex 3114

tracy@pacificcontinentalrealty.com

jim@pacificcontinentalrealty.com